

2400 WEST STREET

4925 SOUTH STREET

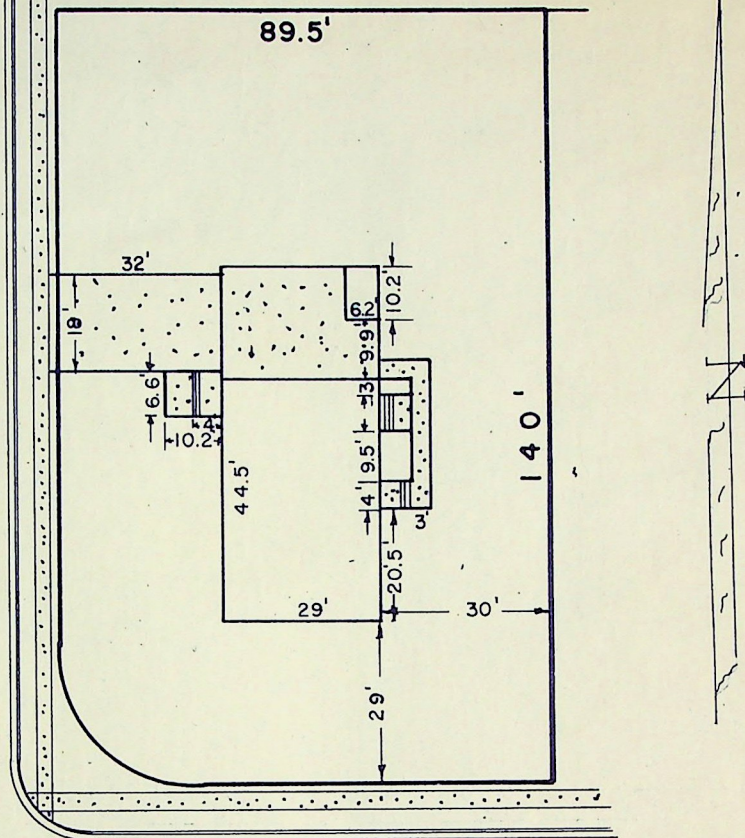

SURVEYOR'S CERTIFICATE

TO WHOM IT MAY CONCERN: I, FRED W. MALAN, do hereby certify that I am a Registered Land Surveyor, and that I hold Certificate No. 1441, as prescribed by the Laws of the State of Utah, and I have made a survey of the following described property:

ALL of Lot 1, BLOCK 2, HY-MESA SUBDIVISION, Roy City, Weber County, Utah

I further certify that the above plat correctly shows the true dimensions of the property surveyed and of the improvements located thereon and their position on the said property: and further that none of the improvements on the above described premises encroach upon adjoining properties, and that no improvements, fences, or eaves of adjoining properties encroach upon the above described property and that there are no violations of the building restriction or zoning ordinances, except as shown and designated on the plat.

Scale: 1" = 30'

June 7, 1958
Date

FRED W. MALAN 2960 VAN BUREN AVE, OGDEN, UTAH
Fred W. Malan
Registered Land Surveyor Certificate No. 1441

Job No. M-33-76

House No. 4925 South 2388 West Roy, Utah